

Fact sheet

Turtlebrace multifunction add-on extension for the fingers

Direct molding extension for immobilizing the fingers, with a bare thermoplastic band for an automatic fusion.

Product

An auto-fusing finger extension that can be applied on the popular Turtlebrace wrist or the Harebrace wrist.

Its unique design permits the immobilization for:

- Boxer fracture
- Ulnar fracture
- Palmar support
- Dorsal support

The great flexibility of the components stabilizes the fingers more easily and with more precision than a traditional brace or cast.



It can be reshaped many times, without losing its qualities, allowing adjustment according to morphologic changes or a specific protocol.

Characteristics

- Universal size.
- Direct molding on the fingers.
- Auto sticking and permanent fusion to the wrist brace (Turtlebrace or Harebrace)
- Can be cut to fit your needs.
- Antibacterial fabric
- Radiotransparent
- Submersible and auto-draining
- Remoldable without limits nor degradation
- 3.2 mm thickness
- Compostable eco-friendly plastic

Distributor



Rafizah A Rashid
Bravada Life Pte Ltd
Tel: +65 9766 1960 / +65 8857 3438
Email: rafizah@bravadalife.com.sg
www.bravadalife.com.sg

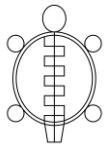

Turtlebrace

Classification

Single patient, non-sterile, non-measuring class 1 medical device.

Indications

Stable fractures, post-op immobilization, tendinitis, serial casting, spasticity control.

Models

Universal (13 cm -15 cm)	EDUA
--------------------------	------

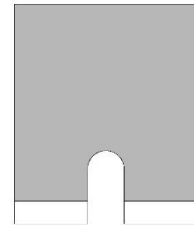

Molding instructions

1- Heat the brace in an oven between 67 °C and 85 °C (152°F and 185°F), or in the Turtlebrace heating bag until it becomes soft and elastic.

Do not use water or water vapor to heat the piece. Moisture will affect the fusion to the brace

- 2- Once the piece has become soft and elastic, you can place the piece according to the need:
- Boxer fracture
 - o Slide the piece in between the 3rd and 4th finger
 - o Press the bare plastic on a dry brace, to fuse the piece to the brace.
 - o Stretch to piece to cover the 4th and 5th finger
 - o Cut the excess material and place the fingers in the proper position.
 - Ulnar fracture
 - o Slide the piece in between the 3rd and 4th finger
 - o Press the bare plastic on a dry brace, to fuse the piece to the brace.
 - o Stretch to piece to cover the 2nd and 3rd finger
 - o Cut the excess material and place the fingers in the proper position.
 - Palmar support
 - o Press a corner bare plastic to one side of a dry brace.
 - o Stretch to piece to cover the sides and the bottom of all fingers.
 - o Press the bare plastic on the dry brace, to fuse the piece to the brace
 - o Cut the excess material and place the fingers in the proper position.

Distributor

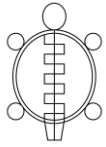

Turtlebrace

- Dorsal support
 - o Press a corner bare plastic to one side of a dry brace. Stretch to piece to cover the top of all fingers
 - o Press the bear plastic on the dry brace, to fuse the piece to the brace
 - o Cut the excess material and place the fingers in the proper position

3- When your client's fingers are in the desired position, wait for the piece to harden.

Once hardened, the piece will keep its shape until you heated it back again.

When fused properly, the piece will remain attached to the brace even if you reheat the full brace.

Precaution of use

Make sure that the temperature of the piece is not too hot for comfort or at risk of burning your client before draping.

The bare plastic can feel hotter than the rest, be careful not to burn your client.

Do not heat the piece over 100°C (210°F), because the fabric could burn or melt.

Moisture will affect the fusion efficiency. Make sure the surfaces, that are going to be fused together, are dry and clean.

If you use a heat gun, be careful not to burn the fabric.

Information

If you have any questions or in need of more information.

- Please contact our distributor:
- Consult our website at www.turtlebrace.com
- Write us at: info@turtlebrace.com

For more information, please contact:

Distributor



Rafizah A Rashid
Bravada Life Pte Ltd
Tel: +65 9766 1960 / +65 8857 3438
Email: rafizah@bravadalife.com.sg
www.bravadalife.com.sg